

Model 9363

Universal Load Cell



APPROVALS

	C3 $n_{lc} \leq 3000$ $Y \leq 9000$
	B10 $n_{lc} \leq 10000$
	Factory Mutual System

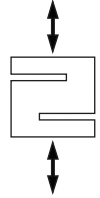

APPLICATIONS

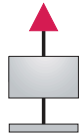
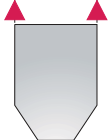
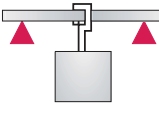
		
Force Measurement	Suspended Hoppers	Overhead Track Scales

DESCRIPTION

The models 363 and 9363 are true multipurpose load cells which can be used in tension and compression. The 363 is made of nickel plated alloy steel, while the 9363 is made of stainless steel.

Both product is suitable for a wide range of hybrid scales, overhead track scales, belt scales and process weighing applications.

Reliable sealing is ensured by the proprietary TRANSEAL potting compound and additional mechanical protection of the strain gauge area.

FEATURES

- Nickel plated (363) and stainless steel (9363) versions
- Certified to OIML R60, 3000d and NTEP IIIIL, 10000 divisions
- Suitable for compression and tension applications
- Trimmed output as standard
- Capacities: **50 → 10000 kg**

9363 SPECIFICATIONS

PARAMETER	VALUE			UNIT
Standard capacities (E_{max})	50, 100, 250, 500, 1000, 2500, 5000, 7500, 10000			kg
Accuracy class according to OIML R-60 / NTEP	Non-Approved	NTEP IIIIL	C3	
Max. no. of verification intervals (n_{Ic})		10000	3000	
Min. verification interval ($V_{min}=E_{max}/Y$)		--	$E_{max}/9000$	
Rated output (=S)	3.0			mV/ V
Rated output tolerance	0.0075			\pm mV/ V
Zero balance	1.0			\pm % FSO
Combined error	0.0500	0.0200	0.0200	\pm % FSO
Non-repeatability	0.0200	0.0100	0.0100	\pm % FSO
Minimum dead load output return *	0.0500		0.0167	\pm % applied load
Creep error (30 minutes)*	0.0600	0.0250	0.0245	\pm % applied load
Creep error (20 - 30 minutes)*	0.0200		0.0053	\pm % applied load
Temp. effect on min. dead load output	0.0250	(0.0010)	0.0070	\pm % FSO/5°C (°F)
Temp. effect on sensitivity	0.0250	(0.0008)	0.0050	\pm % applied load/5°C (°F)
Minimum dead load	0			% E_{max}
Maximum safe over load	150			% E_{max}
Ultimate over load	300			% E_{max}
Maximum safe side load	100			% E_{max}
Excitation voltage	5 to 12			V
Maximum excitation voltage	15			V
Input resistance	430 \pm 60			Ω
Output resistance	350 \pm 3.5			Ω
Insulation resistance	\geq 5000			M Ω
Compensated temperature range	-10 to +40			°C
Operating temperature range	-40 to +80			°C
Storage temperature range	-40 to +90			°C
Element material (DIN)	9363: stainless steel 1.4542, 363: nickel plated alloy steel			
Sealing (DIN 40.050 / EN60.529)	IP67			
SC-Version (current calibration)	Standard			

* Applies for the temperature range -10 to +40 °C

FSO: Full Scale Output

LOAD CELL DIMENSIONS

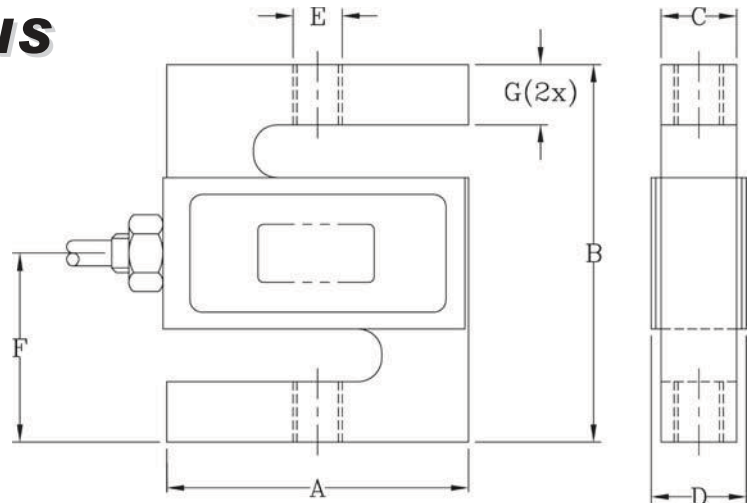

Capacity (kg)	50,100	250,500	1000	2500	5000	7500	10000
A	50.8	50.8	50.8	76.2	74.7	87.4	112.8
B	61.0	61.0	61.0	99.1	99.1	139.7	177.8
C	11.7	18.0	24.4	24.4	30.7	37.1	42.9
D max.	16.5	22.9	29.2	29.2	35.6	41.4	47.8
E (kg)	M8x1.25-6H	M12x1.75-6H	2 M 0x1.5-6H	M24x2-6H	M30x2-6H	M30x2-6H	M30x2-6H
F	30.5	30.5	30.5	49.5	49.3	69.9	88.9
G	8.9	8.9	8.9	14.0	15.7	22.4	31.8

Note: Dimensions in millimeters

Cable specifications:

Cable length: 6m
 Excitation + Red
 Excitation - Black
 Output + Green
 Output - White
 Shield Orange

Cable screen is not connected to load cell body. Performance may be affected if load cell cables are shortened.

REVERE TRANSDUCERS EUROPE B.V.
 Ramshoorn 7
 Postbus 6909, 4802 HX Breda
 The Netherlands
 Tel: (+31) 76-5480700
 Fax: (+31) 76-5412854
 E-mail: info@revere.nl
www.revere.nl

Rabbit Control Systems
 Automation & Control Engineering



803, Riqqa Palace Building
 Al-Maktum Ave. opposite Deira Etisalat
 P.O.Box 181802 Dubai, UAE
 Tel: +9714 - 2270081
 Fax: +9714 - 2239962
 E-mail: rcscsco@eim.ae
www.rcs-co.com