

Instrumentation/Process Control

SURVIVOR® CW-80

Checkweigher Indicator Only



STANDARD FEATURES

- Large, bold 0.8in (20.3mm) Light Emitting Diode (LED) rapid-response display
- Industrial-quality 304 stainless steel construction
- NEMA 4X/IP66 indicator enclosure
- Tough-Touch industrial touch-control front panel with keys for over, under, tare, zero, units, print, target, and ID
- Front-panel "Independent Key Disabling" for: OVER, UNDER, TARE, PRINT and UNITS keys
- Displays units in decimal lb, kg, oz, lb & oz, grams
- Annunciator lights for unit selection
- High-intensity LED for over, under and accept
- Storage for up to 300 tare and tolerance settings
- Automatic zero tracking
- 115VAC or 230VAC operation
- Bidirectional RS-232 and/or simplex 20A current loop communication
- RATTLETRAP® advanced digital filtering
- Combination desk/wall-mount bracket
- Power for up to four 35Ω load cells

APPROVALS



SPECIFICATIONS

DISPLAY:

Large 0.8in 7-segment, 6-digit high-intensity red Light Emitting Diode (LED) display. Decimal point available at each digit

STATUS ANNUNCIATORS:

lb, kg, g, oz, net, motion, center of zero, neg

KEYBOARD:

8-key touch control with international symbols

BAR GRAPH:

5-segment, 7-range programmable multicolored array tracks Over, Under, Accept status in relation to target value

INTERNAL RESOLUTION:

50,000 to 1 million based on filtering selection

DISPLAY RESOLUTION:

Selectable up to 50,000 dd

MEASUREMENT RATE:

25 updates/second

SYSTEM LINEARITY:

0.01% of F.S.

ZERO STABILITY:

100 nV/°C maximum

SPAN STABILITY:

3 ppm/°C maximum

AZM (ZERO TRACK):

Off, ±.5, 1, 2 or 3 dd

OPERATIONAL AZM:

±2% or 100% F.S.

MOTION BAND:

Off, .5, 1, 2, 3, 5, 10 dd

CALIBRATION METHOD:

Software

DIGITAL FILTER:

Software selectable 1, 2, 4, 8, 16, 32, 64, 128

SENSE AMPLIFIER:

Differential amplifier with 6-wire sensing

RFI PROTECTION:

Signal, excitation and sense lines protection. 3V/m for 100kHz to 1GHz, ≤1 μV susceptibility

DIGITAL OUTPUTS:

(Optional) 3 TTL outputs (5VDC) or 3 N/O relays (10 watts, 0.5 amp, 100VDC) or 3 N/C relays (10 watts, 0.5 amp, 100VDC)

EDP PORT:

Full duplex, RS-232 or 20mA simplex output (RS-485 optional)

LINE VOLTAGES:

Available in 109-127 or 208-240VAC models (DC battery backup optional; 24 hrs at 60% duty cycle). Powers 4 x 350Ω load cells

FREQUENCY:

50 or 60Hz

OPERATING TEMPERATURE:

14°F to 104°F (-10°C to 40°C)

APPROVALS:

NTEP - certified per Handbook 44, Class III/III, 10,000d, CC #96-118A1
Measurement Canada approved, AM-5146
CUL and UL listed
CE marked

WARRANTY:

Two-year limited warranty

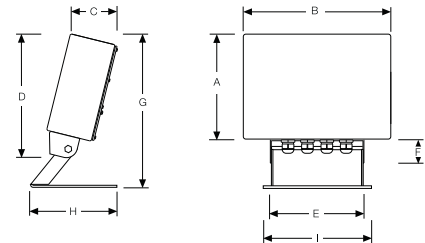

DIMENSIONS			
A	6.75 in (171.5mm)	F	1.50 in (38.1 mm)
B	9.50 in (241.3mm)	G	10.25 in (260.4mm)
C	3.25 in (82.6mm)	H	6.50 in (165.1mm)
D	8.50 in (215.9mm)	I	4.55 in (115.6mm)
E	6.00 in (152.4mm)		