

Instrumentation/Process Control

120/120 Plus

Digital Weight Indicator



STANDARD FEATURES

120

- Large .8in (20.3mm) Light Emitting Diode (LED) Display
- Configurable analog to digital measurement rate
- Power for four 350Ω load cells
- Primary/secondary units configuration: lb, kg, ounces, grams
- Five-button operation
- Two independent communication ports: (1) full duplex, (1) unidirectional or active 20mA current loop
- Standardized EDP command sets
- Programmable ticket format up to two 180-character printout
- Full front-panel digital calibration and configuration
- Tilt stand
- Three-stage digital filtering
- Consecutive transaction numbering
- Time and date (volatile)

120 Plus

- Large .8in backlit LCD display
- Rechargeable battery or wall adapter
- Power save feature for 700 hours of battery life
- Ten stored tare values
- Display hold (based on 3 second average)
- Time and date

APPROVALS



120 Plus - Approvals Pending for Measurement Canada

SPECIFICATIONS

POWER:

120/120 Plus:

Line voltages: 115 or 230VAC
Frequency: 50 or 60Hz

120 Plus:

(estimated battery life)
60 hours with 1 x 350Ω
40 hours with 4 x 350Ω
Charge time 8 hours

EXCITATION VOLTAGE:

5VDC, 4 x 350Ω or 8 x 700Ω load cells

ANALOG SIGNAL INPUT RANGE:

-0.6mV/V - 3.0mV/V

ANALOG SIGNAL SENSITIVITY:

0.3μV/graduation minimum,
1.5μV/grad recommended

RESOLUTION:

Internal resolution:
1 million internal graduations
Display resolution:
10,000 displayed graduations

MEASUREMENT RATE:

120: 30, 15, 7, 3 per second
120 Plus: 30 per second

SYSTEM LINEARITY:

Within 0.01% of full scale

CIRCUIT PROTECTION:

RFI, EMI, ESD protected

LOAD CELL CONNECTION:

Cord grip entry
Detachable plug (optional)

SERIAL OUTPUT:

EDP port: Full duplex RS-232
Printer port: Output-only RS-232 or active 20mA current loop
Both ports: 9600, 4800, 2400, 1200, 600, 300 bps; 7 or 8 data bits; even, odd or no parity

DISPLAY:

120:
0.8in (20mm), 6-digit Red Light Emitting Diode (LED) display, 7-segment digits
120 Plus:
0.8in (20mm) 6-digit LCD with backlight
7-segment digits

STATUS ANNUNCIATORS:

Designators for: center of zero, stand still, gross, net center of zero, standstill, lb, kg, oz, g
*Battery, setpoint 1 & 2, HI-OK-LO, Hold

KEYBOARD:

120:
5-key flat membrane panel, tactile feel
120 Plus:
zero, tare, present tare, hold, gross/net, units, numeric 0-9, clear, enter/print

DIGITAL I/O:

120 Plus: Requires option card
24 volt source
3 digital inputs
2 digital outputs

OPERATING TEMPERATURE:

-10°C to 40°C/14°F to 104°F (legal)
-10°C to 50°C/14°F to 122°F (industrial)

WEIGHT:

2.6lb (1.2kg)

RATING/MATERIAL:

Enclosure: heavy gauge ABS

120 APPROVALS:

NTEP -6,000 Divisions, Class III/III, CC# 03-059A1, Measurement Canada AM-5517, Class III/IIIHD at 6,000 Divisions; OIML approved, TC 7072; T 5692 at 5,000 Divisions
CE marked

120 PLUS APPROVALS:

NTEP -6,000 Divisions, Class III/III, CC# 03-059A1; Measurement Canada Pending OIML approved, TC 7335; T 7334 at 10,000 Divisions

WARRANTY:

One-year limited warranty

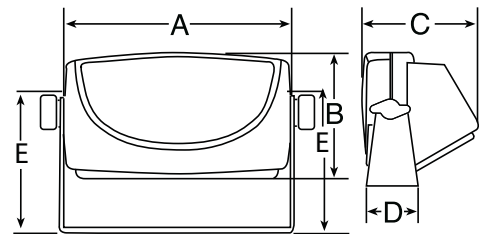

DIMENSIONS

A	7.32 in (1863 mm)	D	1.65 in (42 mm)
B	6.06 in (154 mm)	E	4.76 in (121 mm)
C	3.74 in (95 mm)		